

Dieses Produkt enthält Lichtquellen der Energieeffizienzklasse F.
This product contains light sources of energy class F.

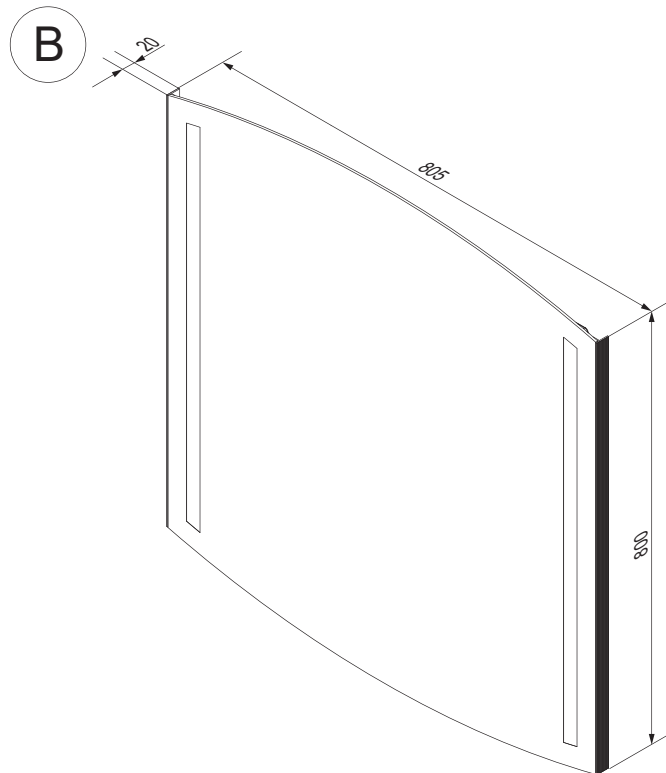
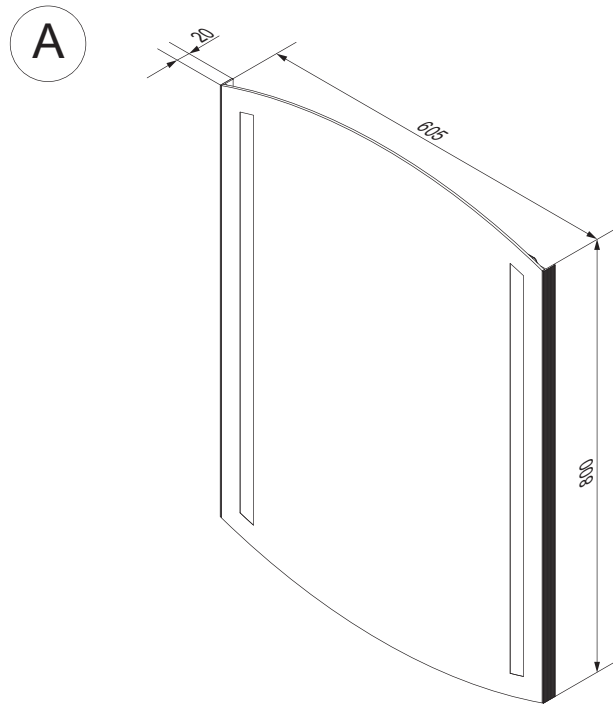
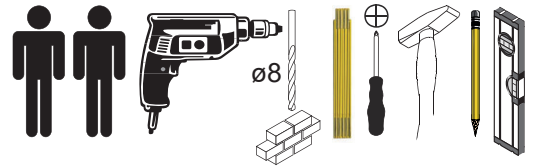

Alle Maßangaben sind ca.-Maße und können geringfügig abweichen.
All measurements are approximate and may vary slightly.

Fackelmann GmbH + Co. KG
Sebastian-Fackelmann-Str. 6
91217 Hersbruck • Deutschland
FAX: 09151/811-294
Servicetelefon: 09151/811-206
servicebm@fackelmann.de
www.fackelmann.com

5MAN844900 S1 20/24

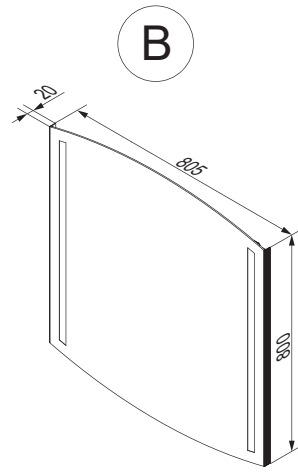
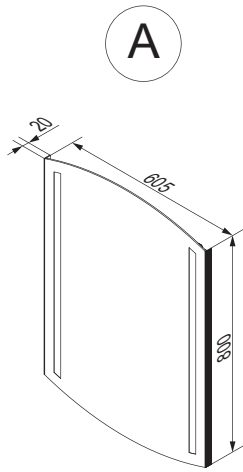

! Alle Maße sind in Millimetern angegeben, unverbindlich, vor Ort zu prüfen und stellen nur eine Empfehlung dar. Änderungen vorbehalten.
 All dimensions are given in millimeters, without obligation, to be checked on site and represent only a recommendation. Subject to change.

1

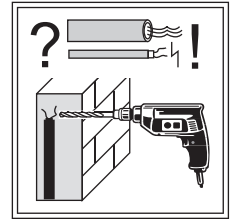
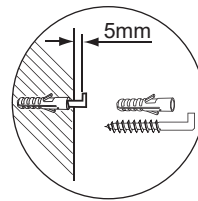
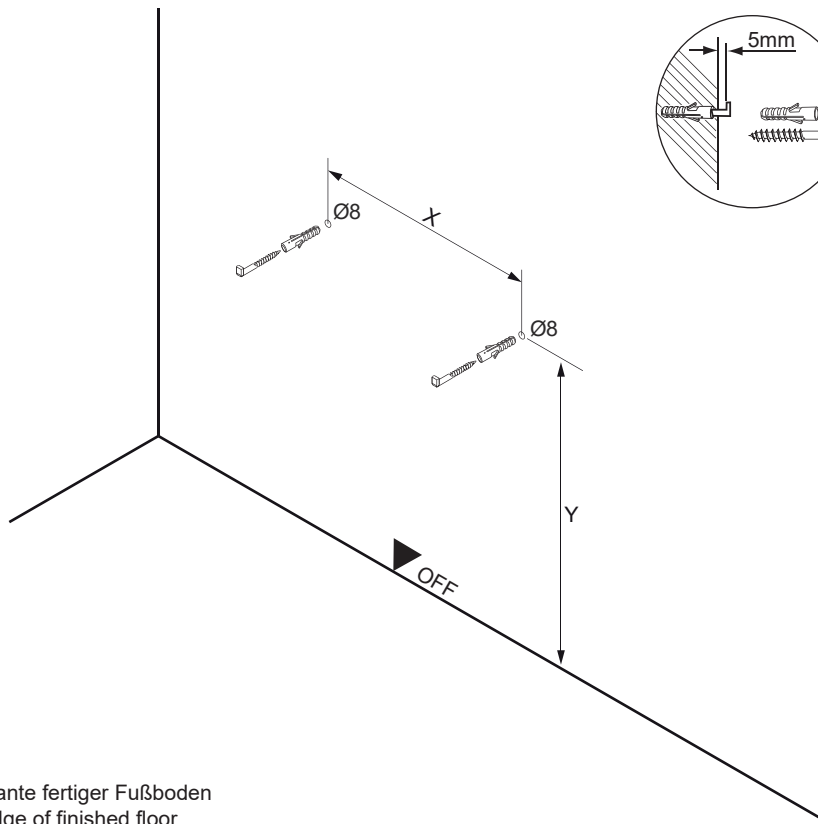

4XBB81HDN0
1 x

Schrank cabinet	Y in mm	X in mm
A	1929	235
B	1929	435

OFF = Oberkante fertiger Fußboden
 Top edge of finished floor

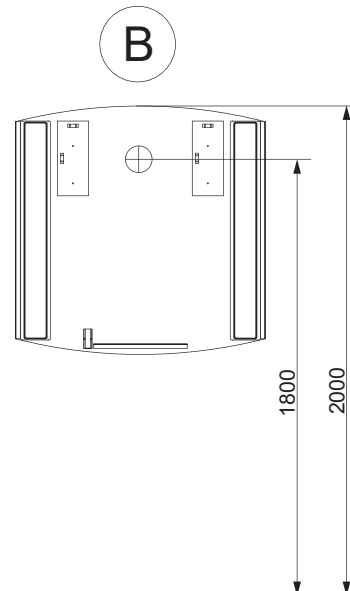
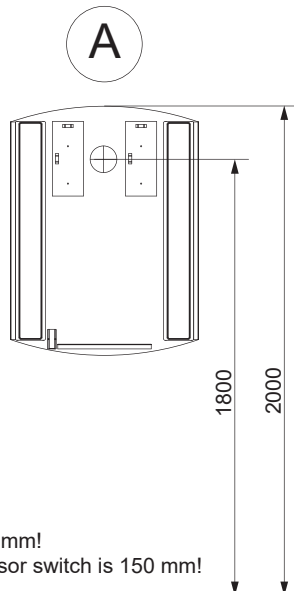

Ansicht von hinten
 View from the back

Mindestabstand zum Sensor 150 mm!
 The minimum distance to the sensor switch is 150 mm!

▼ OFF



**Austausch Sensorschalter/
Change of sensor switch**

Abbildungen beispielhaft.
Arbeitsfolge für alle Artikelnummern identisch.
Illustrations only exemplary.
Identical work sequences for all article numbers.

1

1.1

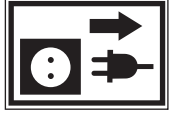

VDE 0100-701 !
IEC 60364-7-701 !

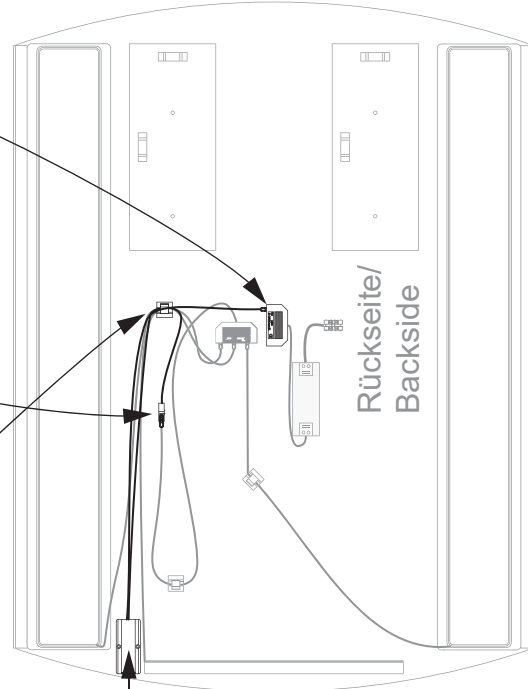
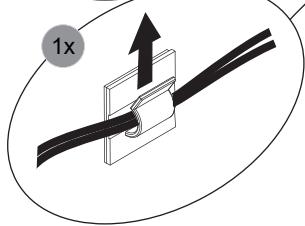
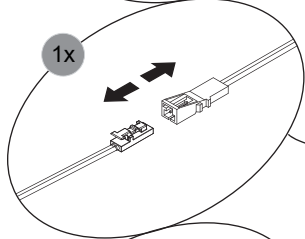
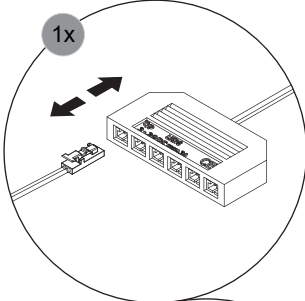

1.3

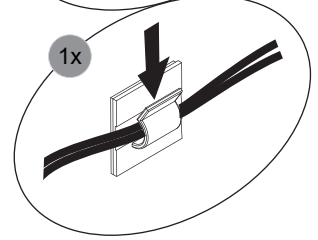
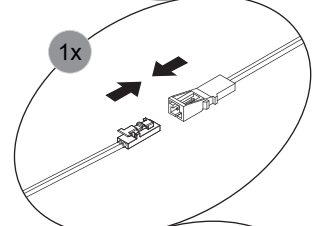
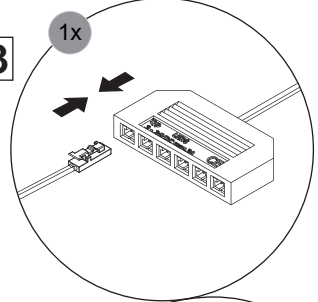

Ersatzteil/
Replacement part

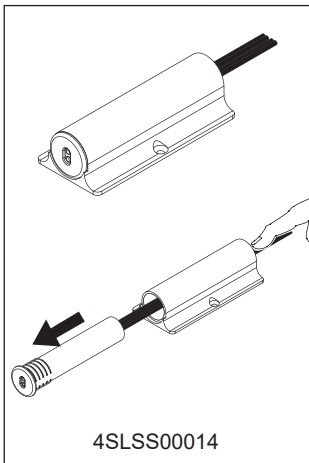

1 x

1.2

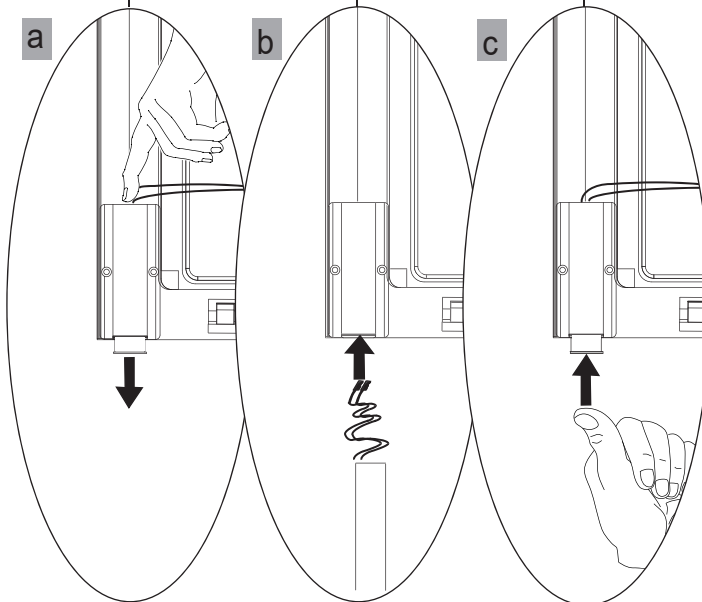



Austausch LED-Band der
Ambientebeleuchtung/
Change of LED-stripe of the
ambient lighting



Abbildungen beispielhaft.
Arbeitsfolge für alle Artikelnummern identisch.
Illustrations only exemplary.
Identical work sequences for all article numbers.

1

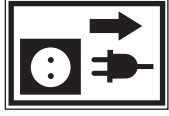

1.1



VDE 0100-701 !
IEC 60364-7-701 !

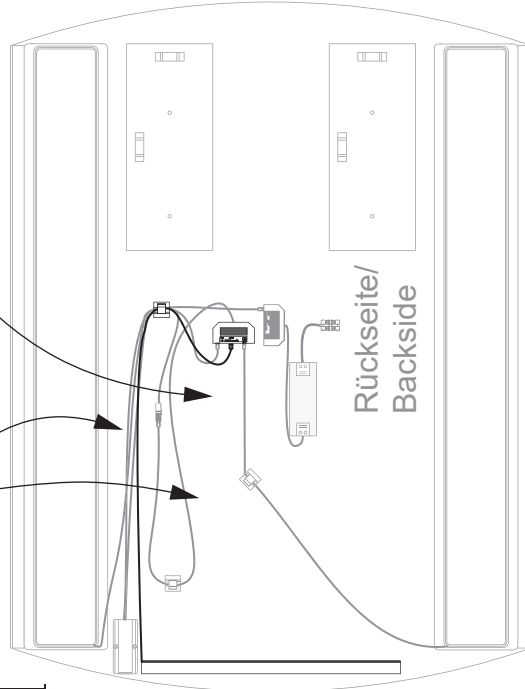
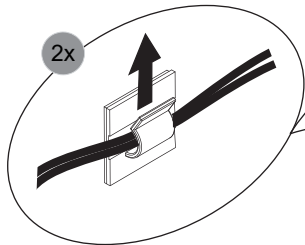
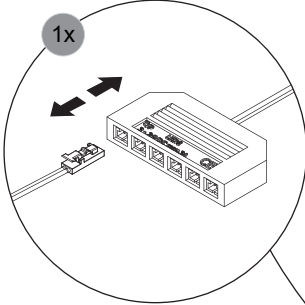

1.3

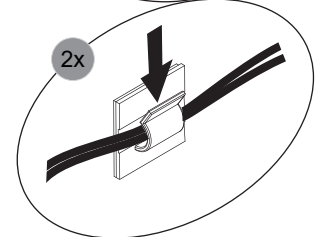
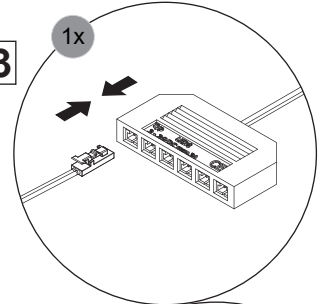

1.2

Ersatzteil/Replacement part	
4SL0845120	 1x

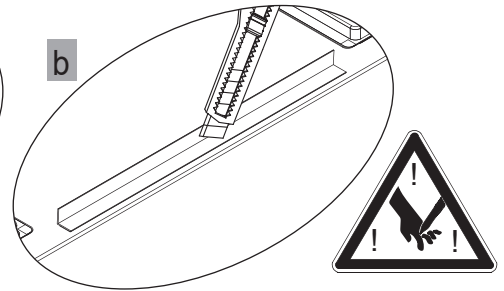
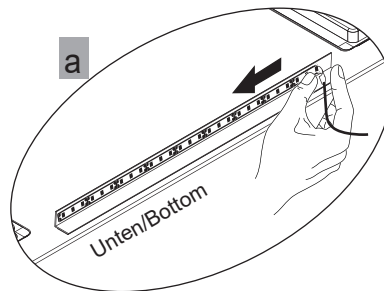
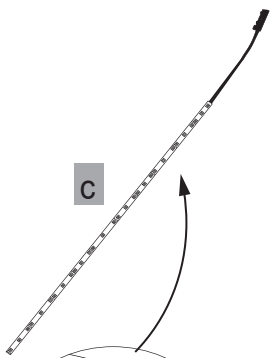

ACHTUNG: Heiß!
Caution! Hot!

Kleberreste vorsichtig entfernen/
Remove adhesive residues carefully

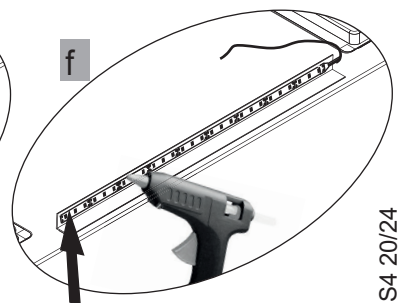
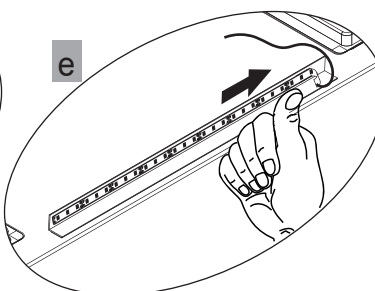
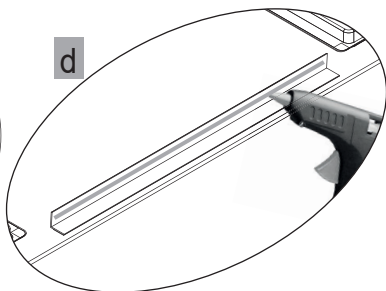
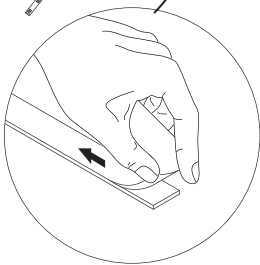

Obere Kante des LED-Bandes
mit Heißkleber fixieren/
Fix **upper edge** of LED-stripe
with hot glue



max. 30sec.

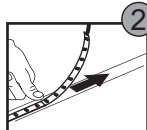



Austausch Kunststoffschalen
mit LED-Band/
Change of plastic shell with
LED-stripe

Abbildungen beispielhaft.
Arbeitsfolge für alle Artikelnummern identisch.
Illustrations only exemplary.
Identical work sequences for all article numbers.

1

1.1

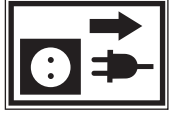

VDE 0100-701 !
IEC 60364-7-701 !

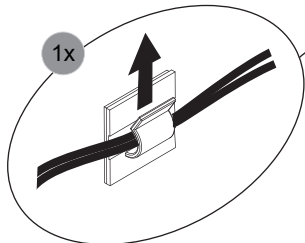
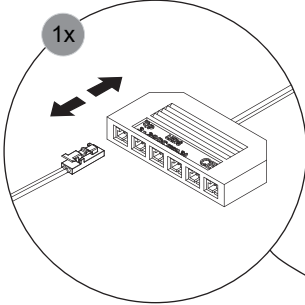

2MLSR84502

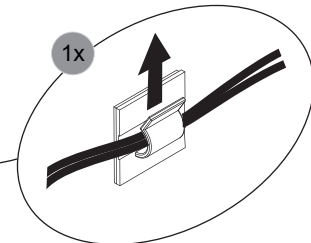
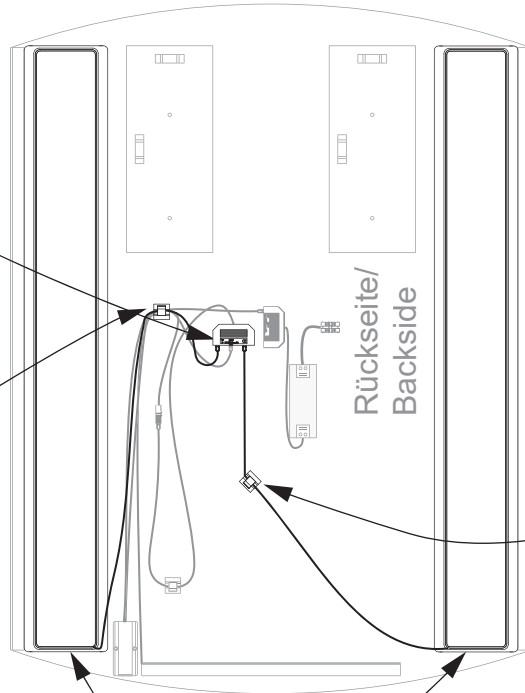

2MLSL84502

2MLSR84502
Frontansicht rechts / front view right

2MLSL84502
Frontansicht links / front view left

1.2

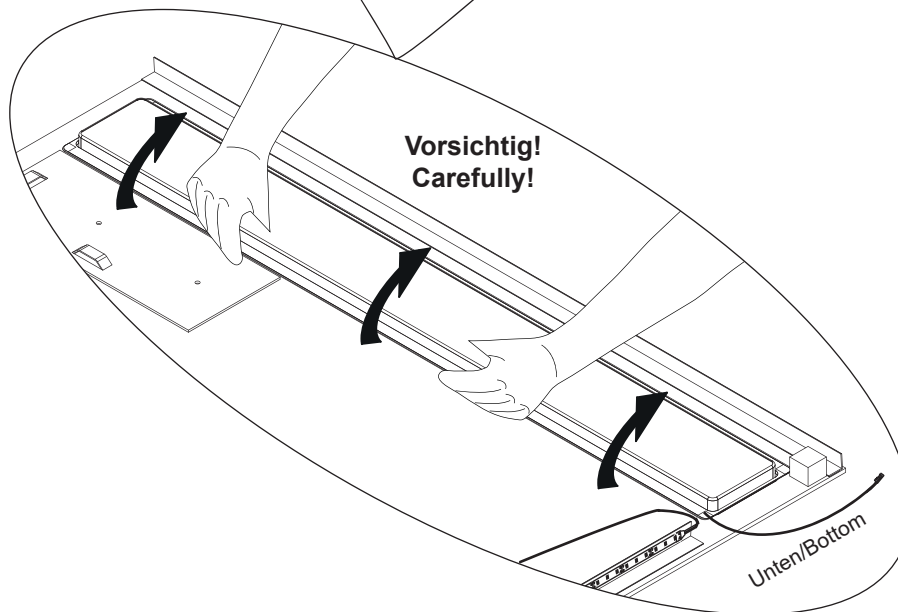



Austausch Kunststoffschalen
mit LED-Band/
Change of plastic shell with
LED-stripe

Abbildungen beispielhaft.
Arbeitsfolge für alle Artikelnummern identisch.
Illustrations only exemplary.
Identical work sequences for all article numbers.

1.5

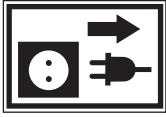

VDE 0100-701 !
IEC 60364-7-701 !

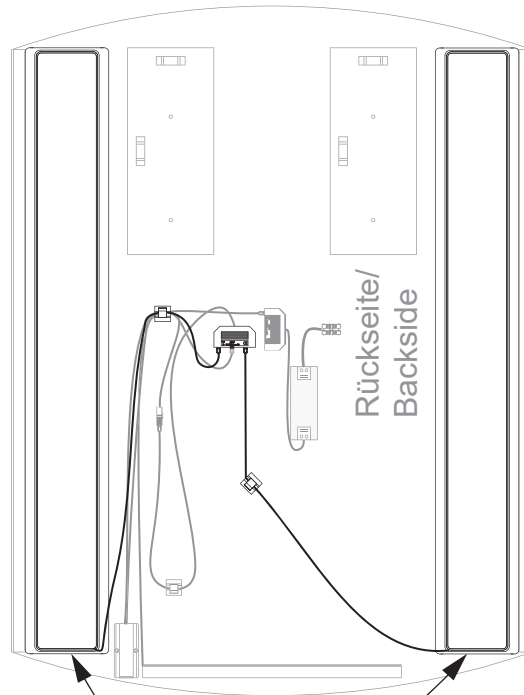

1.4

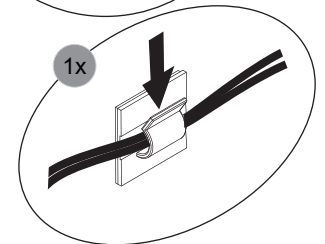
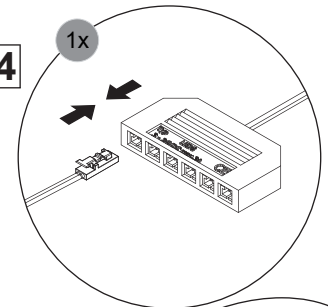

2MLSR84502
Frontansicht rechts / front view right

2MLS84502
Frontansicht links / front view left

1.3

